

# VL5118-5

Five lamp vanity with clear glass

## INSTALLATION SHEET

- 1.** Remove the fixture from its original packaging. Remove the canopy mounting plate from within the canopy and attach it to the electrical junction box, and wall, using the two screws provided in the hardware package.
- 2.** Attach the canopy to the mounting plate which is attached to the electrical junction box on the wall.
- 3.** First attach all wiring with the provided marrets (white to white "N", black to black "L", ground to ground "G").
- 4.** Push the canopy onto the mounting plate and align the four holes (two above & two below) on the canopy to the holes on the mounting plate. Once aligned, screw in the four screws provided to secure the fixture to the wall.
- 5.** Install the glass cover onto the fixture. After it, You can now install G9 bulbs of the correct wattage.
- 6.** You have now completed the installation of your fixture, please enjoy.

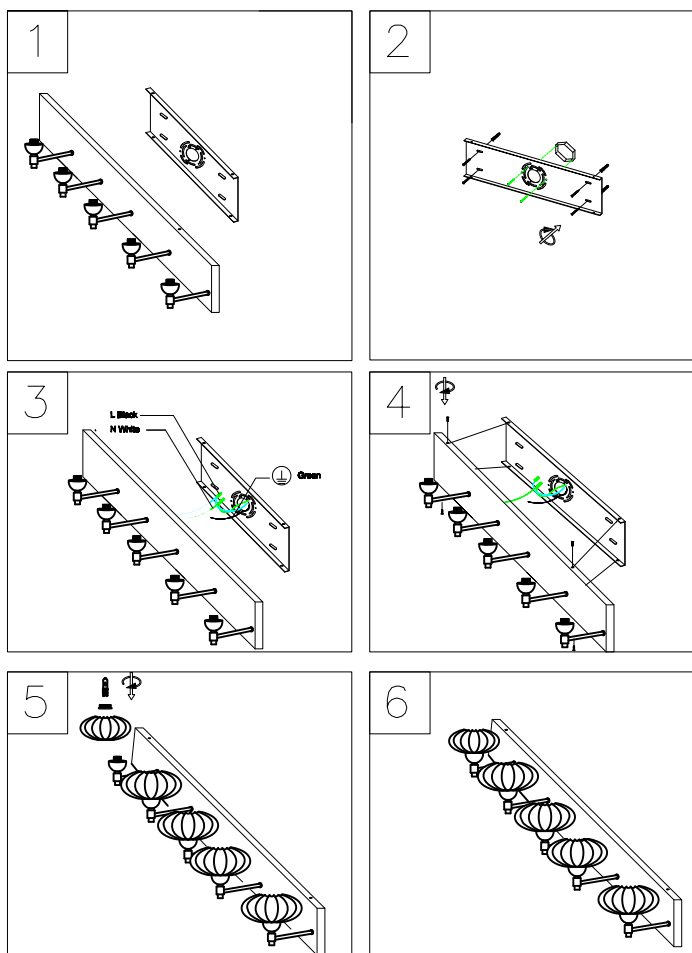

### Please note:

- Make sure power is completely off at the fuse box.
- Have your fixture installed by a qualified licensed electrician
- Prepare everything in clear area.
- Wear gloves at all times during this installation.
- Read instructions carefully before you start assembly.
- Keep this instruction sheet for future reference.